

**TOP REBATE**

SCALE 1:5

INFORMATION TABLE	
CONCRETE TYPE	MINIMUM N40
CONCRETE COVER	30mm MINIMUM
CONCRETE VOLUME	0.284m <sup>3</sup>
LIFTER TYPE & QTY	2 - 1.3T x 55 FA
MASS	710KG

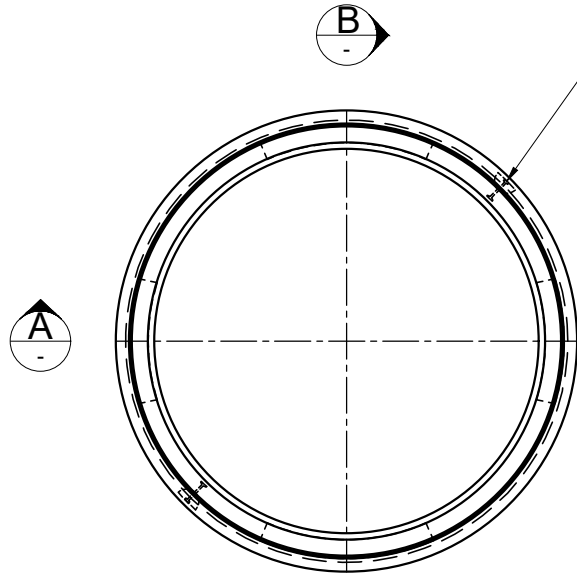

**PLAN VIEW**

NOT ALL DETAILS SHOWN FOR CLARITY

2 - 1.3T x 55 LONG SWIFTLIFT FOOT ANCHORS (250 DOWN)

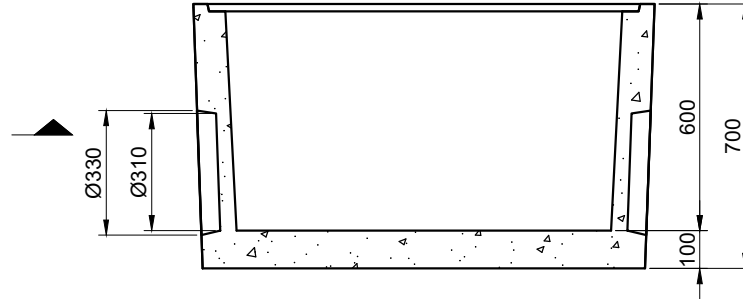

**SECTION A**

NOT ALL DETAILS SHOWN FOR CLARITY

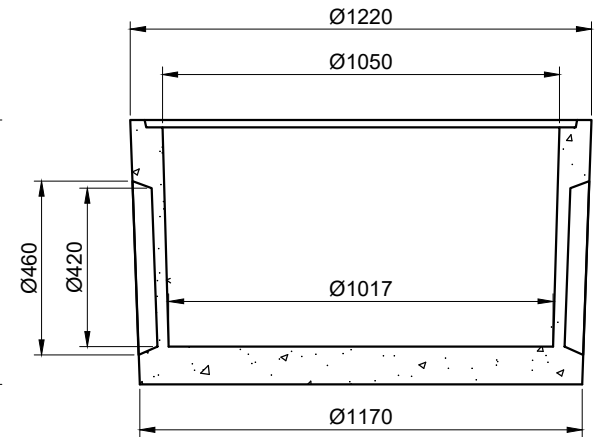

**SECTION B**

NOT ALL DETAILS SHOWN FOR CLARITY

**NOTES:**

1. MANUFACTURED FROM MINIMUM N40 CONCRETE
2. REINFORCEMENT AS PER HCP STANDARD DESIGN
3. CONCRETE COVER & CONCRETE STRENGTH VARIES FOR SPECIFIC APPLICATIONS
4. ALL DIMENSIONS ARE SHOWN NOMINAL AND MAY VARY BETWEEN CASTING FACILITIES WITH DIFFERENCES IN MANUFACTURING MOULDS AND PRACTICES

**DISCLAIMER:**  
 SHOP DRAWING ONLY, DESIGN BY OTHERS. SITE CONTRACTOR & INSTALLER MUST UNDERTAKE SITE & PROJECT SPECIFIC RISK ASSESSMENT/SWMS AROUND SAFE LIFTING & HANDLING OF PRODUCT

**CP2326 - STANDARD DN1050  
 x 600 MANHOLE BASE UNIT**

REV	AMENDMENTS	DRAWN	DATE	APPR.	NOTES
0	ISSUED FOR DRAWING REGISTER	D.S.	24/03/22	M.R.	

DRAWN	CHECKED	DATE
D.S.	M.R.	24 MARCH 2022

SCALE	PAPER
1:20	A4
JOB NUMBER	DRAWING
FAC-MH1050-06CB	



**HUDSON**  
 CIVIL PRODUCTS

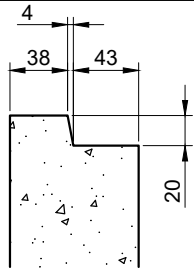

**TOP REBATE**

SCALE 1:5

INFORMATION TABLE	
CONCRETE TYPE	MINIMUM N40
CONCRETE COVER	30mm MINIMUM
CONCRETE VOLUME	0.380m <sup>3</sup>
LIFTER TYPE & QTY	2 - 1.3T x 55 FA
MASS	950KG

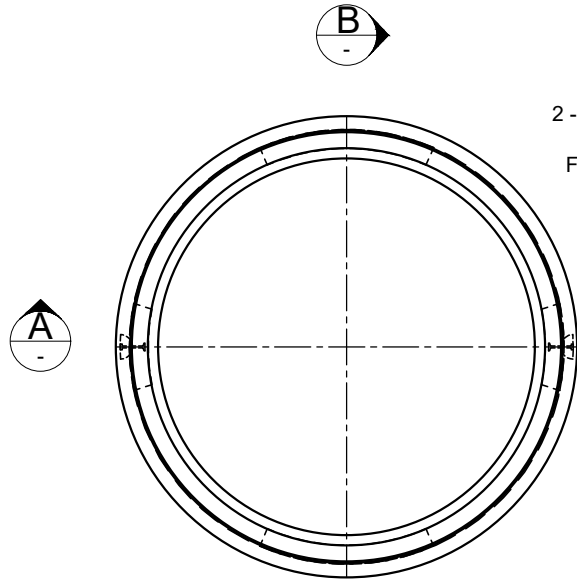

**PLAN VIEW**

NOT ALL DETAILS SHOWN FOR CLARITY

2 - 1.3T x 55 LONG SWIFTLIFT FOOT ANCHORS

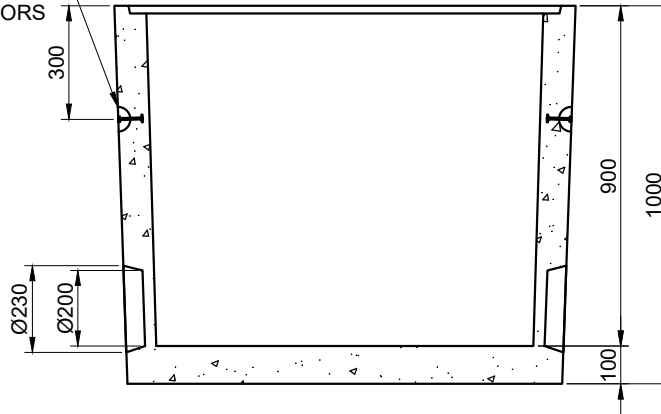

**SECTION A**

NOT ALL DETAILS SHOWN FOR CLARITY

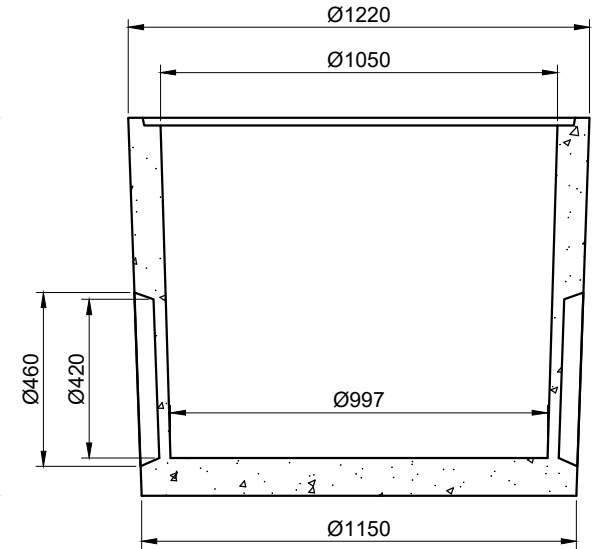

**SECTION B**

NOT ALL DETAILS SHOWN FOR CLARITY

**NOTES:**

1. MANUFACTURED FROM MINIMUM N40 CONCRETE
2. REINFORCEMENT AS PER HCP STANDARD DESIGN
3. CONCRETE COVER & CONCRETE STRENGTH VARIES FOR SPECIFIC APPLICATIONS
4. ALL DIMENSIONS ARE SHOWN NOMINAL AND MAY VARY BETWEEN CASTING FACILITIES WITH DIFFERENCES IN MANUFACTURING MOULDS AND PRACTICES

**DISCLAIMER:**  
 SHOP DRAWING ONLY, DESIGN BY OTHERS. SITE CONTRACTOR & INSTALLER MUST UNDERTAKE SITE & PROJECT SPECIFIC RISK ASSESSMENT/SWMS AROUND SAFE LIFTING & HANDLING OF PRODUCT

**CP2329 - STANDARD DN1050  
 x 900 MANHOLE BASE UNIT**

REV	AMENDMENTS	DRAWN	DATE	APPR.	NOTES
0	ISSUED FOR DRAWING REGISTER	D.S.	24/03/22	M.R.	

DRAWN	CHECKED	DATE
D.S.	M.R.	24 MARCH 2022

SCALE	PAPER
1:20	A4
JOB NUMBER	DRAWING
FAC-MH1050-09CB	



**HUDSON**  
 CIVIL PRODUCTS

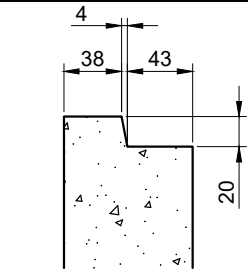

**TOP REBATE**

SCALE 1:5

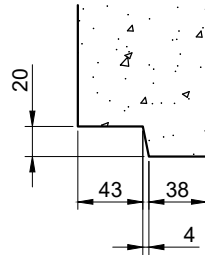

**BOTTOM REBATE**

SCALE 1:5

INFORMATION TABLE	
CONCRETE TYPE	MINIMUM N40
CONCRETE COVER	30mm MINIMUM
CONCRETE VOLUME	0.091m <sup>3</sup>
LIFTER TYPE & QTY	2 - 1.3T x 55 FA
MASS	230KG

2 - 1.3T x 55 LONG SWIFTLIFT FOOT ANCHORS

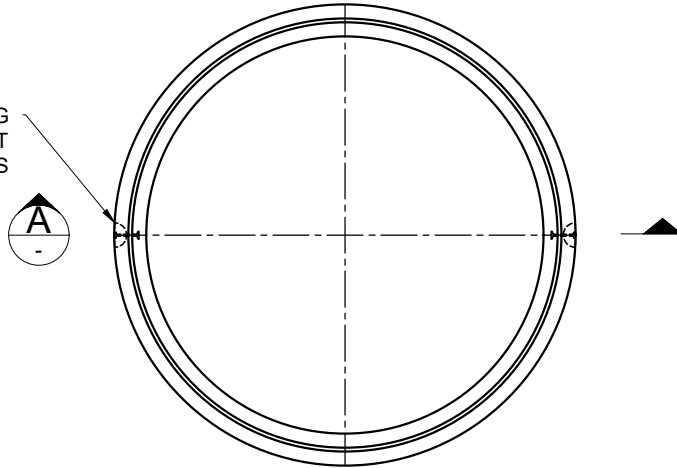

**PLAN VIEW**

NOT ALL DETAILS SHOWN FOR CLARITY

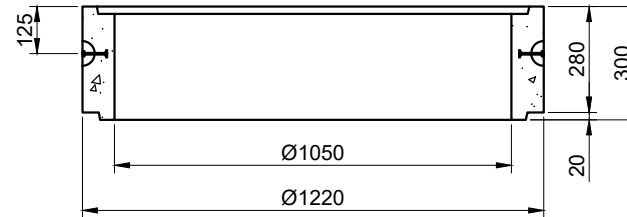

**SECTION A**

NOT ALL DETAILS SHOWN FOR CLARITY

**NOTES:**

1. MANUFACTURED FROM MINIMUM N40 CONCRETE
2. REINFORCEMENT AS PER HCP STANDARD DESIGN
3. CONCRETE COVER & CONCRETE STRENGTH VARIES FOR SPECIFIC APPLICATIONS
4. ALL DIMENSIONS ARE SHOWN NOMINAL AND MAY VARY BETWEEN CASTING FACILITIES WITH DIFFERENCES IN MANUFACTURING MOULDS AND PRACTICES

**DISCLAIMER:**  
 SHOP DRAWING ONLY, DESIGN BY OTHERS. SITE CONTRACTOR & INSTALLER MUST UNDERTAKE SITE & PROJECT SPECIFIC RISK ASSESSMENT/SWMS AROUND SAFE LIFTING & HANDLING OF PRODUCT

**CP2300 - STANDARD DN1050  
 x 300 MANHOLE SHAFT**

REV	AMENDMENTS	DRAWN	DATE	APPR.	NOTES
0	ISSUED FOR DRAWING REGISTER	M.R.	16/07/20	A.H.	
1	DRAWING NUMBER UPDATED	M.R.	15/09/21		
2	REBATE DETAILS ADDED	M.R.	24/03/22		

DRAWN	CHECKED	DATE
M.R.	A.H.	16 JULY 2020

SCALE	PAPER
1:20	A4
JOB NUMBER	DRAWING
FAC-MH1050-03C	



**HUDSON**  
 CIVIL PRODUCTS

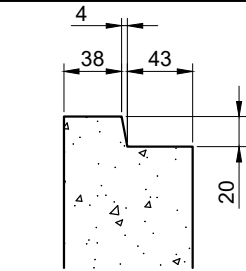

**TOP REBATE**

SCALE 1:5

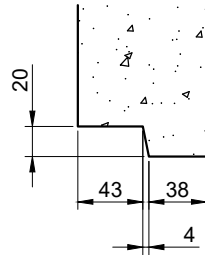

**BOTTOM REBATE**

SCALE 1:5

INFORMATION TABLE	
CONCRETE TYPE	MINIMUM N40
CONCRETE COVER	30mm MINIMUM
CONCRETE VOLUME	0.194m <sup>3</sup>
LIFTER TYPE & QTY	2 - 1.3T x 55 FA
MASS	485KG

2 - 1.3T x 55 LONG SWIFTLIFT FOOT ANCHORS

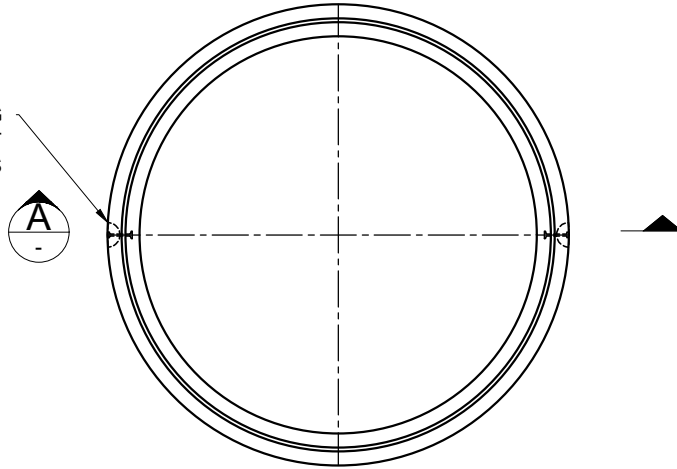

**PLAN VIEW**

NOT ALL DETAILS SHOWN FOR CLARITY

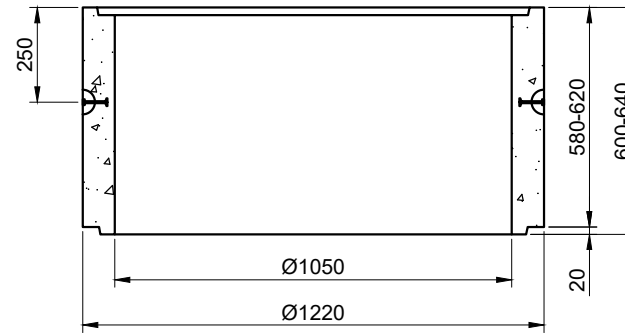

**SECTION A**

NOT ALL DETAILS SHOWN FOR CLARITY

**NOTES:**

1. MANUFACTURED FROM MINIMUM N40 CONCRETE
2. REINFORCEMENT AS PER HCP STANDARD DESIGN
3. CONCRETE COVER & CONCRETE STRENGTH VARIES FOR SPECIFIC APPLICATIONS
4. ALL DIMENSIONS ARE SHOWN NOMINAL AND MAY VARY BETWEEN CASTING FACILITIES WITH DIFFERENCES IN MANUFACTURING MOULDS AND PRACTICES

**DISCLAIMER:**  
 SHOP DRAWING ONLY, DESIGN BY OTHERS. SITE CONTRACTOR & INSTALLER MUST UNDERTAKE SITE & PROJECT SPECIFIC RISK ASSESSMENT/SWMS AROUND SAFE LIFTING & HANDLING OF PRODUCT

**CP2306 - STANDARD DN1050  
 x 600 MANHOLE SHAFT**

REV	AMENDMENTS	DRAWN	DATE	APPR.	NOTES
0	ISSUED FOR DRAWING REGISTER	M.R.	16/07/20	A.H.	
1	DRAWING NUMBER UPDATED	M.R.	15/09/21		
2	REBATE DETAILS ADDED	M.R.	24/03/22		

DRAWN	CHECKED	DATE
M.R.	A.H.	16 JULY 2020

SCALE	PAPER
1:20	A4
JOB NUMBER	DRAWING
FAC-MH1050-06C	



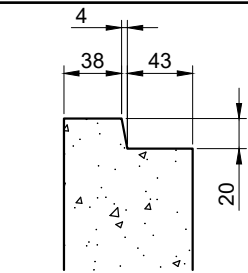

**TOP REBATE**

SCALE 1:5

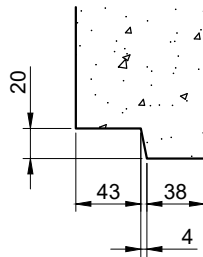

**BOTTOM REBATE**

SCALE 1:5

INFORMATION TABLE	
CONCRETE TYPE	MINIMUM N40
CONCRETE COVER	30mm MINIMUM
CONCRETE VOLUME	0.285m <sup>3</sup>
LIFTER TYPE & QTY	2 - 1.3T x 55 FA
MASS	715KG

2 - 1.3T x 55 LONG SWIFTLIFT FOOT ANCHORS

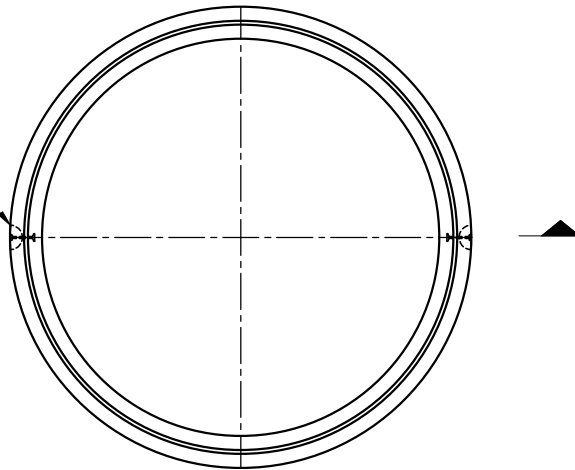

**PLAN VIEW**

NOT ALL DETAILS SHOWN FOR CLARITY

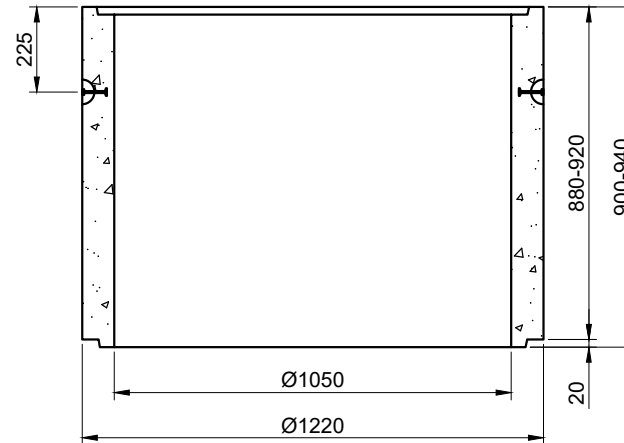

**SECTION A**

NOT ALL DETAILS SHOWN FOR CLARITY

**NOTES:**

1. MANUFACTURED FROM MINIMUM N40 CONCRETE
2. REINFORCEMENT AS PER HCP STANDARD DESIGN
3. CONCRETE COVER & CONCRETE STRENGTH VARIES FOR SPECIFIC APPLICATIONS
4. ALL DIMENSIONS ARE SHOWN NOMINAL AND MAY VARY BETWEEN CASTING FACILITIES WITH DIFFERENCES IN MANUFACTURING MOULDS AND PRACTICES

**DISCLAIMER:**  
 SHOP DRAWING ONLY, DESIGN BY OTHERS. SITE CONTRACTOR & INSTALLER MUST UNDERTAKE SITE & PROJECT SPECIFIC RISK ASSESSMENT/SWMS AROUND SAFE LIFTING & HANDLING OF PRODUCT

**CP2309 - STANDARD DN1050  
 x 900 MANHOLE SHAFT**

REV	AMENDMENTS	DRAWN	DATE	APPR.	NOTES
0	ISSUED FOR DRAWING REGISTER	M.R.	16/07/20	A.H.	
1	DRAWING NUMBER UPDATED	M.R.	15/09/21		
2	REBATE DETAILS ADDED	M.R.	24/03/22		

STANDARD PRODUCT DRAWING		
DRAWN	CHECKED	DATE
M.R.	A.H.	16 JULY 2020

SCALE	PAPER
1:20	A4
JOB NUMBER	DRAWING
FAC-MH1050-09C	



**HUDSON**  
 CIVIL PRODUCTS

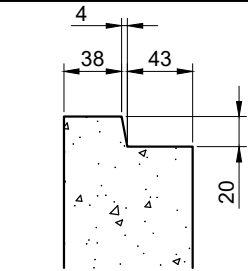

**TOP REBATE**

SCALE 1:5

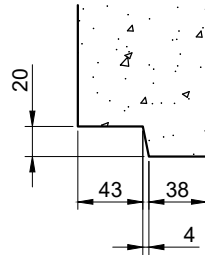

**BOTTOM REBATE**

SCALE 1:5

INFORMATION TABLE	
CONCRETE TYPE	MINIMUM N40
CONCRETE COVER	30mm MINIMUM
CONCRETE VOLUME	0.370m <sup>3</sup>
LIFTER TYPE & QTY	2 - 1.3T x 55 FA
MASS	925KG

2 - 1.3T x 55 LONG SWIFTLIFT FOOT ANCHORS

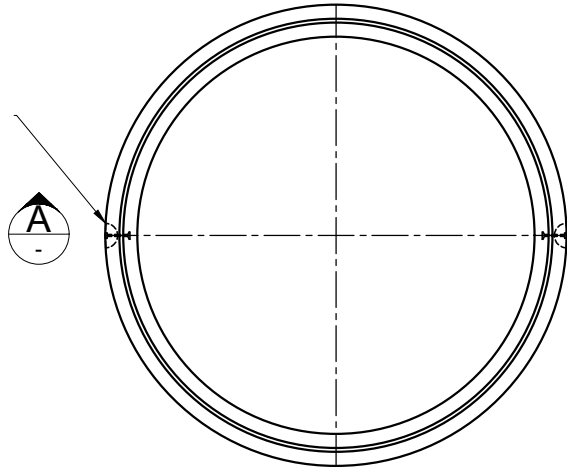

**PLAN VIEW**

NOT ALL DETAILS SHOWN FOR CLARITY

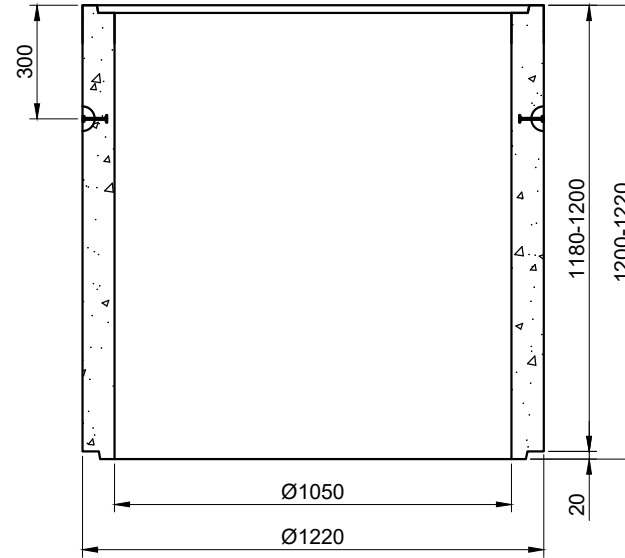

**SECTION A**

NOT ALL DETAILS SHOWN FOR CLARITY

**NOTES:**

1. MANUFACTURED FROM MINIMUM N40 CONCRETE
2. REINFORCEMENT AS PER HCP STANDARD DESIGN
3. CONCRETE COVER & CONCRETE STRENGTH VARIES FOR SPECIFIC APPLICATIONS
4. ALL DIMENSIONS ARE SHOWN NOMINAL AND MAY VARY BETWEEN CASTING FACILITIES WITH DIFFERENCES IN MANUFACTURING MOULDS AND PRACTICES

**DISCLAIMER:**  
 SHOP DRAWING ONLY, DESIGN BY OTHERS. SITE CONTRACTOR & INSTALLER MUST UNDERTAKE SITE & PROJECT SPECIFIC RISK ASSESSMENT/SWMS AROUND SAFE LIFTING & HANDLING OF PRODUCT

**CP2312 - STANDARD DN1050 x 1200 MANHOLE SHAFT**

REV	AMENDMENTS	DRAWN	DATE	APPR.	NOTES
0	ISSUED FOR DRAWING REGISTER	M.R.	16/07/20	A.H.	
1	DRAWING NUMBER UPDATED	M.R.	15/09/21		
2	REBATE DETAILS ADDED	M.R.	24/03/22		

STANDARD PRODUCT DRAWING		
DRAWN	CHECKED	DATE
M.R.	A.H.	16 JULY 2020

SCALE	PAPER
1:20	A4
JOB NUMBER	DRAWING
FAC-MH1050-12C	



**HUDSON**  
 CIVIL PRODUCTS

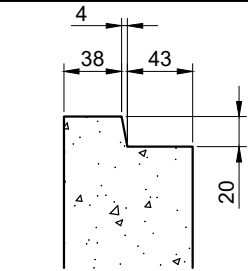

**TOP REBATE**

SCALE 1:5

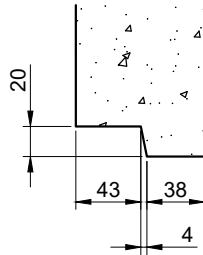

**BOTTOM REBATE**

SCALE 1:5

INFORMATION TABLE	
CONCRETE TYPE	MINIMUM N40
CONCRETE COVER	30mm MINIMUM
CONCRETE VOLUME	0.455m <sup>3</sup>
LIFTER TYPE & QTY	2 - 1.3T x 55 FA
MASS	1150KG

2 - 1.3T x 55 LONG SWIFTLIFT FOOT ANCHORS

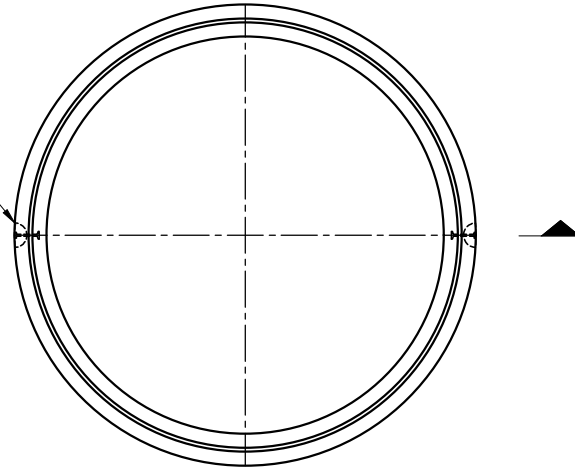

**PLAN VIEW**

NOT ALL DETAILS SHOWN FOR CLARITY

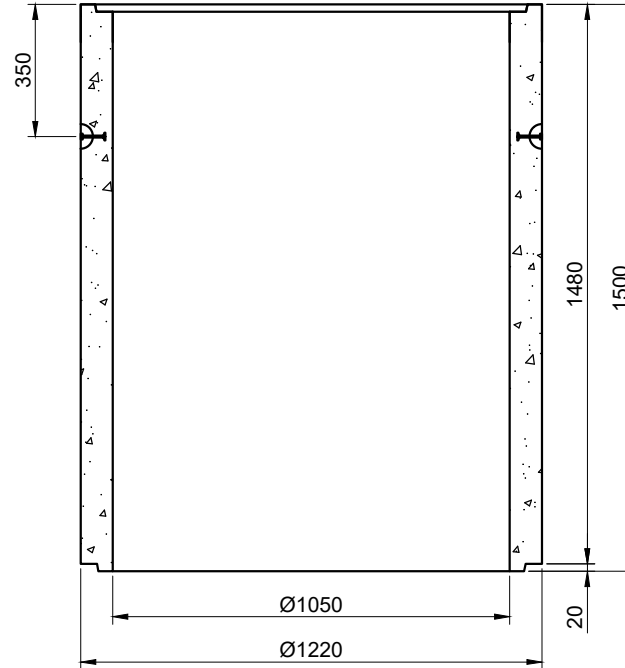

**SECTION A**

NOT ALL DETAILS SHOWN FOR CLARITY

**NOTES:**

1. MANUFACTURED FROM MINIMUM N40 CONCRETE
2. REINFORCEMENT AS PER HCP STANDARD DESIGN
3. CONCRETE COVER & CONCRETE STRENGTH VARIES FOR SPECIFIC APPLICATIONS
4. ALL DIMENSIONS ARE SHOWN NOMINAL AND MAY VARY BETWEEN CASTING FACILITIES WITH DIFFERENCES IN MANUFACTURING MOULDS AND PRACTICES

**DISCLAIMER:**  
 SHOP DRAWING ONLY, DESIGN BY OTHERS. SITE CONTRACTOR & INSTALLER MUST UNDERTAKE SITE & PROJECT SPECIFIC RISK ASSESSMENT/SWMS AROUND SAFE LIFTING & HANDLING OF PRODUCT

**CP2315 - STANDARD DN1050  
 x 1500 MANHOLE SHAFT**

REV	AMENDMENTS	DRAWN	DATE	APPR.	NOTES
0	ISSUED FOR DRAWING REGISTER	M.R.	16/07/20	A.H.	
1	DRAWING NUMBER UPDATED	M.R.	15/09/21		
2	REBATE DETAILS ADDED	M.R.	24/03/22		

DRAWN	CHECKED	DATE
M.R.	A.H.	16 JULY 2020

SCALE	PAPER
1:20	A4
JOB NUMBER	DRAWING
FAC-MH1050-15C	



**HUDSON**  
 CIVIL PRODUCTS