



Hudson Environmental 'Pit Trap' - At source pollution control

Hudson Environmental has launched its 'Pit Trap' into the Tasmanian market to expand our range of stormwater quality improvement devices to include 'at source' to complement our range of 'end of line' devices.

The 'Pit Trap' is manufactured in Tasmania and is available off the shelf to suit Hudson Civil Products precast kerb and grate units. We can also manufacture one off traps to be retrofitted on site for existing pits.

Benefits of a Hudson Environmental 'Pit Trap'

- Our basket is fabricated from corrosion resistant lightweight Aluminium allowing the capture of pollutants above 4mm
- Optional Polyester liner for the capture of finer particles down to 1mm and smaller.
- Captured materials remain in a dry state eliminating odours, mosquitos and reducing the weight of the basket for cleaning purposes.
- Baskets supplied in a 'mechanical empty only' design without handles to eliminate employees removing the trap by hand with the associated risks of strain injuries.
- Our Polyester liner comes with stainless steel fixings and penetrations are made with stainless steel eyelets. This liner is then attached to the aluminium basket to alleviate any strain on the liner when being emptied or manhandled.
- Built in bypass on top of the large surface area of the basket allows high flows to enter the drainage system without the remobilisation of pollutants.
- Large capacity basket holds 0.15 m³ when full.

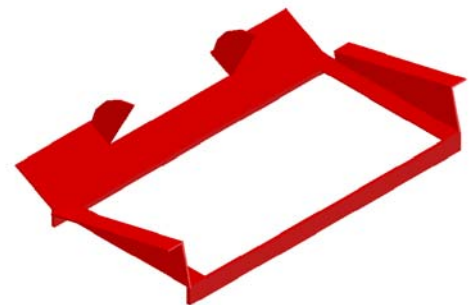

A simple design for a simple problem

The 'Pit Trap' design is based on a common sense approach to the problems of gross pollutants entering the stormwater system and therefore our creeks and estuaries. Our design simply consists of a robust aluminium sub frame which is positioned in the grate seat into which an aluminium basket is lowered into position. This basket in its basic form will collect all pollutants larger than 4mm. Items that fall into this category are cigarette butts, plastic drinking bottle caps and large type aggregates. For additional performance to collect pollutants above 1mm, we offer an additional welded polyester liner that is simply fitted inside the aluminium basket. These baskets can be cleaned by either hi-ab truck or pump trucks. We do not encourage the use of handles as the force and location of the lift is potentially very dangerous.

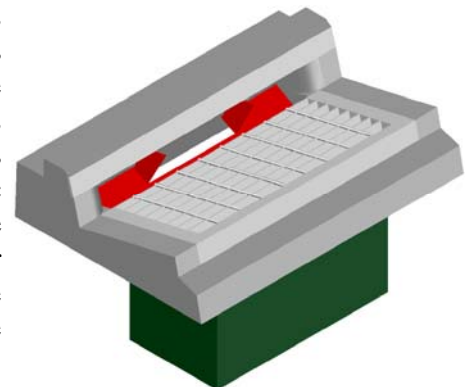

Why use a rigid basket?

Hudson Environmental, as a division of Hudson Civil Pty Ltd, is a locally owned business specifically targeting the Tasmanian market. We do not have the problems that large mainland and multinational company's face when trying to cover a market the size of Australia.

Basically, a rigid frame makes sense unless you are freighting them large distances like across Bass Strait and the Nullarbor as the costs are prohibitive. As we are not affected by these cost restrictions, we have the ability to design products that are constructed from the most suitable designs and materials.

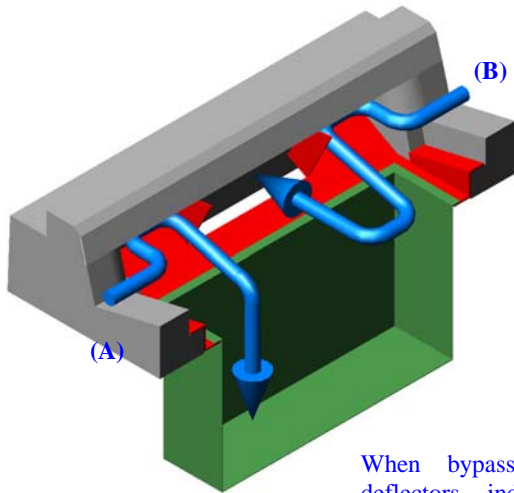

When bypass occurs (B), the deflectors induce a flow that prevents remobilisation of pollutants previously captured (A).

Maintenance

When the basket is full, excess water is diverted through the bypass at the back of the pit (a large amount of water will still pass through the basket even when full). ALL baskets when full will allow the remobilisation of pollutants so an adequate maintenance regime must be put in place to ensure the correct operation of the baskets.

Construction site filters

We also provide filter fabric liners for installation when site works produce an increased amount of fine particles. These liners are disposable one use items and are both more cost effective and reliable than traditional 'silt socks'.

